

Cabinet Member for a Greener Powys



County Hall
Llandrindod Wells
Powys
LD1 5LG

17/04/2023

For further information please contact

steve.boyd@powys.gov.uk

01597 826374

NOTICE OF INTENDED PORTFOLIO HOLDER DELEGATED DECISION

The Portfolio Holder has received the following report for a decision to be taken under delegated authority. The decision will be taken on **21/04/2023** (i.e. 3 clear days after the date of this note). The decision will be published on the Council's website but will not be implemented until 5 clear days after the date of publication of the decision) to comply with the call-in process set out in Rule 7.35 of the Constitution.

1.	PROHIBITION OF DRIVING ALONG PART OF NEW ROAD, MONTGOMERY
----	--

(Pages 3 - 12)

2.	SPEED LIMIT REVIEW - VARIOUS ROADS, MONTGOMERY
----	---

(Pages 13 - 34)

This page is intentionally left blank

CYNGOR SIR POWYS COUNTY COUNCIL
PORTFOLIO HOLDER DELEGATED DECISION
by
COUNTY COUNCILLOR JACKIE CHARLTON
PORTFOLIO HOLDER FOR A GREENER POWYS
April 2023

REPORT AUTHOR: Traffic Engineer North, Highways & Technical Services

REPORT TITLE: Prohibition of Driving along part of New Road,
Montgomery.

REPORT FOR: Decision

1. Purpose

- 1.1. This report seeks to secure portfolio holder authorisation for local highway authority traffic officers to commence the traffic regulation order consultation and implementation process to introduce prohibition of driving traffic management along part of the U4810 county unclassified road known as New Road at Montgomery.

2. Background

- 1.1. Full planning consent reference 20/2118/FUL has been secured by a developer to erect 33 affordable local need dwellings, formation of vehicular access road and all associated works on land off Forden Road, Montgomery. One of the developer's obligations with respect to their planning consent is to create a link road between the estate road and the U4810 and put into effect associated traffic management works along the U4810 to prevent motorised vehicles from utilising the existing junction of New Road with Forden Road. A traffic regulation Order would be required to manage the traffic movements along New Road.
- 1.2. The developer has already paid the Council's fee to process the prohibition of driving traffic regulation Order.
- 1.3. The developer will also be funding the required civil engineering works to construct a turning area at the north-western end of New Road, the erection of appropriate traffic signage, the placement of traffic bollards at the end of the turning area, and the introduction of earthworks to prevent motor vehicles travelling along that part of New Road between the new turning area and its junction with the B4388 county classified road known as Forden Road.

- 1.4. The residential development proposals have been designed to permit some flexibility in the final design, whereby the western end of New Road can either remain as a no through road for motorised vehicles being accessible from Chirbury Road only or be constructed as a link road to permit motorised vehicles travelling along New Road to access Forden Road via the new adoptable residential estate road and vice versa.
- 1.5. To avoid any confusion and for the purposes of clarity, the proposed prohibitions contained within the traffic order are identified on a plan and as written descriptions of individual traffic movement prohibitions along those roads within the draft Order. The plan is attached at Appendix A and will be available to view on site notices and on the Council's website during the public consultation phase of the traffic order making process.
- 1.6. The Council's statement of reasons is attached to this report at Appendix B.
- 1.7. The most recent drawing submitted by the developer which shows the proposed engineering works to prevent the passage of motorised traffic through the existing New Road/Forden Road junction is attached to this report at Appendix C.

2. Advice

- 2.1. No other options are available for consideration at this stage of the Traffic Regulation Order proposal process.
- 2.2. The County Council has engaged with the Town Council and the county councillor whose ward is directly affected by the proposed traffic management controls.
- 2.3. The proposals support the CIP priority of improving our transport infrastructure by making it safer for people to use the highways within this part of Montgomery and to encourage active travel movements.

3. Resource Implications

- 4.1 All costs associated with the consultation process, the implementation of the Traffic Regular Order and the associated engineering works, carriageway markings and signage will be funded by the developer.
- 4.2 The Head of Finance (Section 151 Officer) notes the content of the report.

5. Legal implications

- 5.1. The Principal Legal Assistant (North) has reviewed the proposals and confirms it is within our power as long as the correct process is followed.

5.2. The Head of Legal Services and the Monitoring Officer has commented as follows: “I note the legal comment and have nothing to add to the report”.

6. Data Protection

3.1. Personal data will be collected from responses to the public consultation and is essential to undertake this statutory requirement for making a Traffic Regulation Order. This data will be collected and managed in accordance with the privacy notice that is published on the Traffic Order Consultation page on our website.

3.2. The Data Protection Officer notes the processing of personal data in connection with this proposal and makes no further comment.

7. Comments from local members

7.1. The proposal will affect residents, businesses, and visitors to Montgomery. Cllr Jeremy Brignell-Thorp has expressed his support for the proposal, as have Dyfed-Powys Police and Montgomery Town Council.

8. Integrated Impact Assessment

8.1. An impact assessment is not required.

Recommendation:	Reason for Recommendation:
<p>1. To authorise the local highway authority to commence the legal public consultation procedure for the proposed traffic regulation order relating to new traffic movement prohibitions at Montgomery identified at Appendix A to the report, and if no substantive objections are received implement the prohibition of waiting Order in accordance with the Local Authorities’ Traffic Orders (Procedure) (England and Wales) Regulations 1996.</p>	<p>To introduce the traffic movement prohibition order required to facilitate the permitted housing development off Forden Road adjacent to New Road in Montgomery.</p>

<p>Relevant Policy:</p>	<p>Corporate Improvement Plan 2021-25 : Improve our Infrastructure to Support Regeneration and Attract Investment - We will actively compete for any grant funding opportunities, and subject to such funding, deliver transport infrastructure projects, develop active travel, support suitable transport options and improve road safety.</p>		
<p>Within Policy:</p>	<p>Y /N</p>	<p>Within Budget:</p>	<p>Y /N</p>

<p>Relevant Local Member(s):</p>	<p>Cllr Jeremy Brignell-Thorp - member for the</p>
----------------------------------	---

	Fornden and Montgomery ward.
--	-------------------------------------

Person(s) To Implement Decision:	Chris Lloyd
Date By When Decision To Be Implemented:	As soon as possible

Is a review of the impact of the decision required?	Y/ N
--	-------------

Contact Officer:	Chris Lloyd
Tel:	01686 611563
Email:	chris.lloyd@powys.gov.uk
Head of Service:	Matt Perry
Corporate Director:	Nigel Brinn

Background Papers used to prepare Report:

- **Appendix A - Proposed traffic movement prohibition plans.**
- **Appendix B - Statement of reasons.**
- **Appendix C – Engineering works.**

DELEGATED DECISION NEW REPORT TEMPLATE VERSION 3

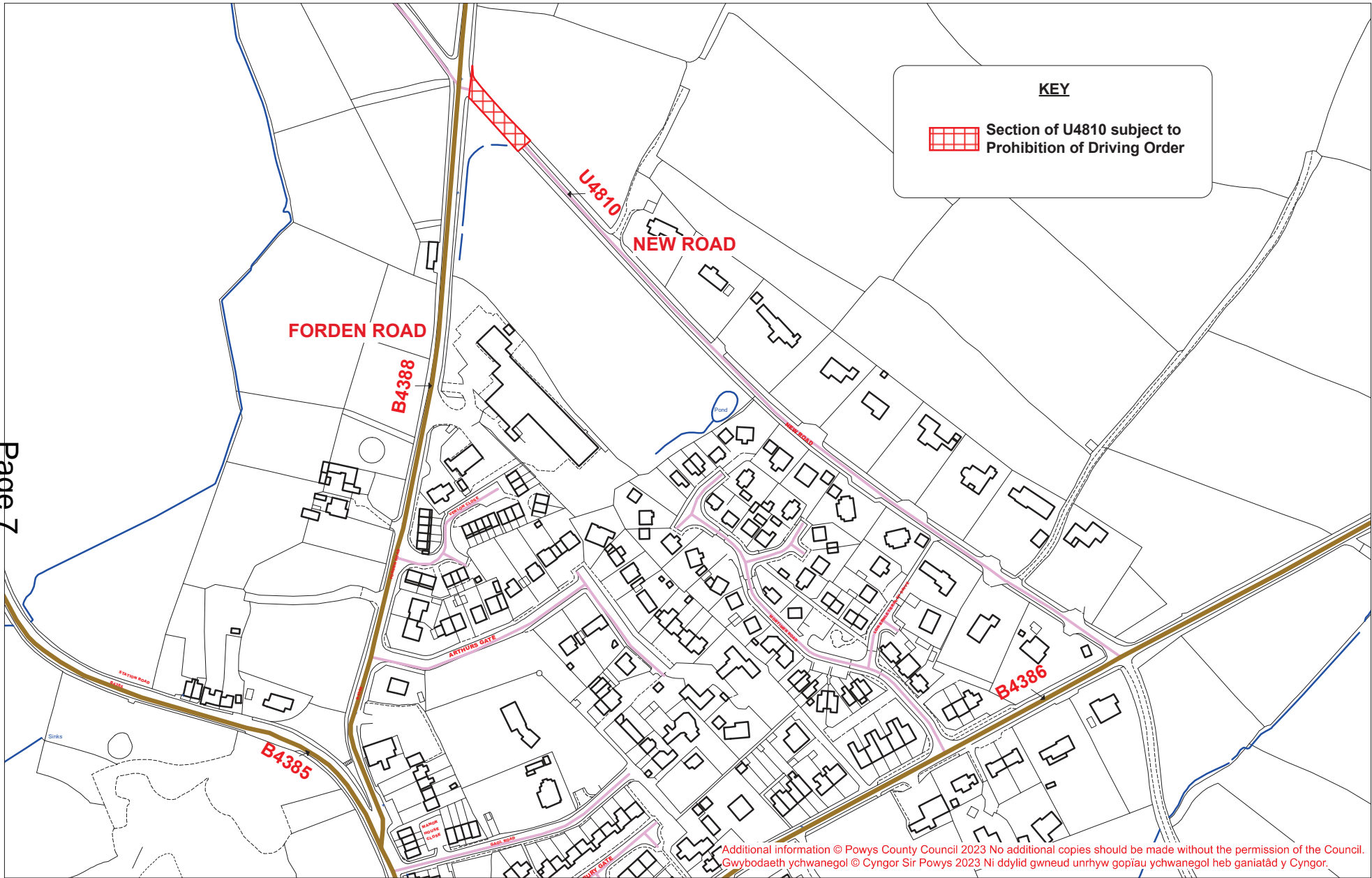

Additional information © Powys County Council 2023 No additional copies should be made without the permission of the Council.
 Gwybodaeth ychwanegol © Cyngor Sir Powys 2023 Ni ddylid gwneud unrhyw gopiau ychwanegol heb ganiatâd y Cyngor.

This page is intentionally left blank

**The County of Powys
(U4810 New Road, Montgomery)
(Prohibition Of Driving) Order 2023**

Statement of Reasons

Full planning consent reference 20/2118/FUL has been secured by a developer to erect 33 affordable local need dwellings, formation of vehicular access road and all associated works on land off Forden Road, Montgomery. One of the developer's obligations with respect to their planning consent is to create a link road between the estate road and the U4810 and put into effect associated traffic management works along the U4810 to permit motorised vehicles from utilising the existing junction of New Road with Forden Road. A traffic regulation Order would be required to manage the traffic movements along New Road.

The developer has already paid the Council's fee to process the prohibition of driving traffic regulation Order.

The developer will also be funding the required civil engineering works to construct a turning area at the north-western end of New Road, the erection of appropriate traffic signage, the placement of traffic bollards at the end of the turning area, and the introduction of earthworks to prevent motor vehicles travelling along that part of New Road between the new turning area and its junction with the B4388 county classified road known as Forden Road.

The residential development proposals have been designed to permit some flexibility in the final design, whereby the western end of New Road can either remain as a no through road for motorised vehicles being accessible from Chirbury Road only or be constructed as a link road to permit motorised vehicles travelling along New Road to access Forden Road via the new adoptable residential estate road and vice versa.

To avoid any confusion and for the purposes of clarity, the proposed prohibitions contained within the traffic order are identified on a plan and as written descriptions of individual traffic movement prohibitions along those roads within the draft Order. The plan is attached at Appendix A and will be available to view on site notices and on the Council's website during the public consultation phase of the traffic order making process.

This page is intentionally left blank

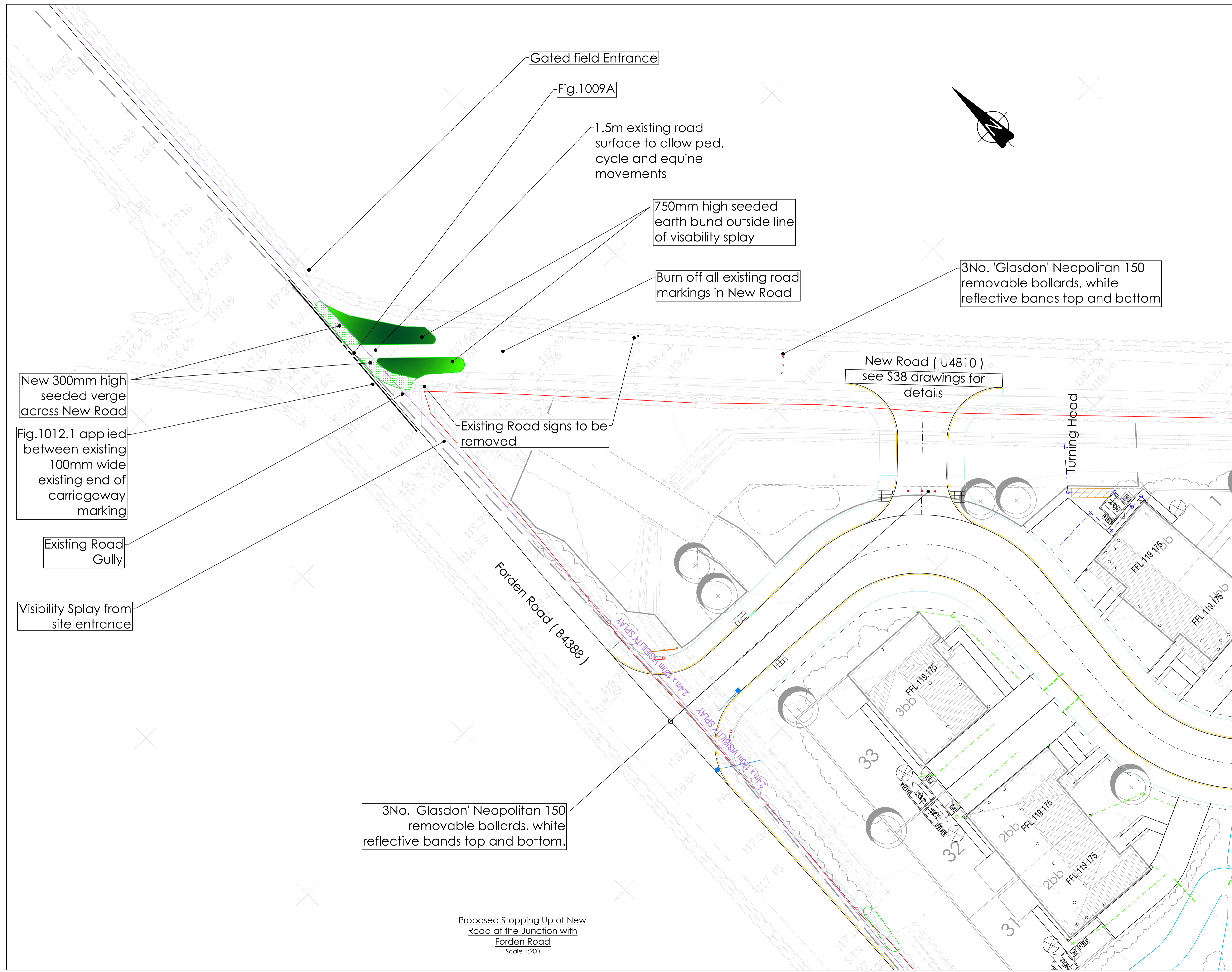

Construction Methodology for verge and bund:-
 Saw cut existing New Road surface and remove road make-up and sub-base to a depth of at least 450mm.
 Verge - seeded clay soil to 300mm above existing road surface, batter steeply to Forden Road side.
 Bund - Seeded soil bund to a max height of 750mm above existing road level. The bund is to be wholly outside the site entrance visibility splay.

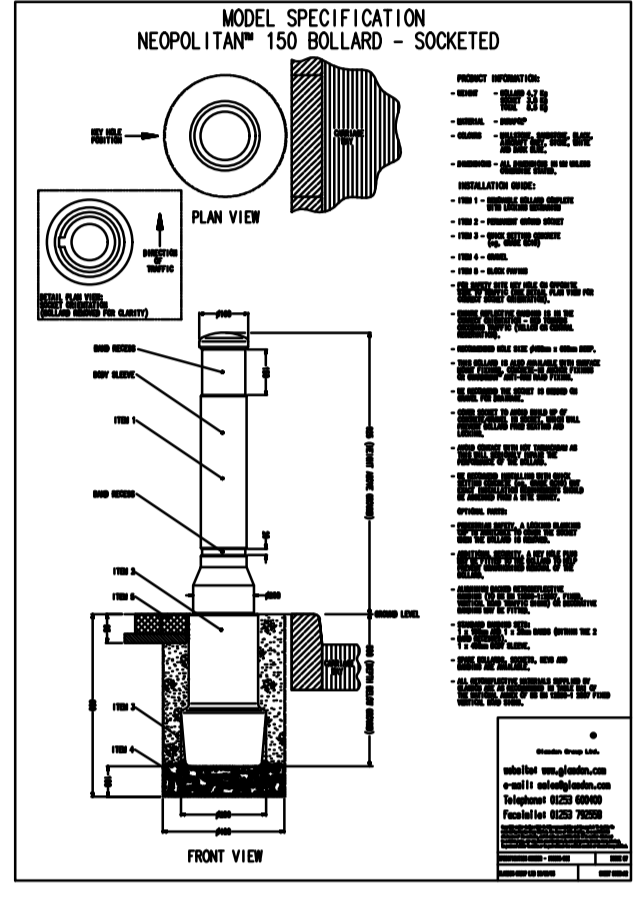

Rev	Date	Details	By
P4	06/03/23	Scale of drawing amended to suit S38 comments	GW
P3	14/11/22	Updated to suit R4 comments	GW
P2	13/10/22	Band and verge to junction of Forden and New Road issued for information	GW
P1	05/08/22	Issued for information	GW

Drawing originator:
BETTS HYDRO CONSULTING ENGINEERS
BETTS ASSOCIATES CONSULTING ENGINEERS
BETTS GEO CONSULTING ENGINEERS



Client:
 Land Off Forden Road
 Montgomery

Drawing title:
 Planning Condition 4
 Discharge Drawing
 Stopping Up of New Rd at Forden Rd

Scale: 1:200 @ A1 for the original size of A1
 Drawn by: GW | Checked by: XX | Passed by: XX | Date: Aug 2022

Information						
Job No:	Drawing No:	Project:	Origin:	Volume:	Level:	Type:
PSH04						
Number:	Disc:	Revision:				
805		P4				

Do not scale this drawing
 4-7 Old Marsh Farm Barns, Welsh Road, Sealand, Flintshire, CH5 2Y7
 enquiries@betts-associates.co.uk
 Chester 01244 288178 | Altrincham 0161 413531

Page 11

Proposed Stopping Up of New Road at the Junction with Forden Road
 Scale 1:200

This page is intentionally left blank

CYNGOR SIR POWYS COUNTY COUNCIL
PORTFOLIO HOLDER DELEGATED DECISION
by
COUNTY COUNCILLOR JACKIE CHARLTON
PORTFOLIO HOLDER FOR A GREENER POWYS
April 2023

REPORT AUTHOR: Traffic Engineer North, Highways & Technical Services

REPORT TITLE: Speed Limit Review – Various Roads, Montgomery.

REPORT FOR: Decision

1. Purpose

- 1.1. This report seeks to secure portfolio holder authorisation for local highway authority traffic officers to commence the traffic regulation order consultation and implementation process to modify the extents of the existing speed limits and introduce new speed limits along various roads in the town of Montgomery following discussions with the Town Council. The Order would also revoke the existing restricted roads speed limit Orders within the town of Montgomery.

2. Background

- 1.1. Full planning consent reference 20/2118/FUL has been secured by a developer to erect 33 affordable local need dwellings, formation of vehicular access road and all associated works on land off Forden Road, Montgomery. One of the developer's obligations with respect to their planning consent is to modify the extent of the existing 30mph speed limit and introduce a new 40mph buffer zone speed limit along Forden Road. A traffic regulation Order would be required to modify the speed limits along Forden Road.
- 1.2. The developer has already paid the Council's fee to process the speed limit traffic regulation Order.
- 1.3. The developer will also be funding the required signage and carriageway markings associated with the new and modified speed limits along Forden Road and New Road.
- 1.4. As part of the same traffic regulation Order proposal, the local highway authority is seeking to make modifications to the existing speed limits on other roads within the town of Montgomery to take into account traffic speed concerns raised by Montgomery Town Council and to eliminate minor discrepancies that currently exist between the existing

restricted roads traffic regulation Order extents and the existing locations of certain speed limit terminal signs.

- 1.5. A small number of non-illuminated speed limit terminal signs will need to be erected along Llandyssil Road and Bishop's Castle Street to facilitate the modified speed limit proposal; and the existing non-illuminated 30mph speed limit signs will need to be relocated further along Station Road to facilitate the new speed limit Order. These minor costs will be funded by the local highway authority.
- 1.6. The new speed limit Order will specify which sections of road will be designated as 30mph and 40mph speed limit roads, and which sections of road will be designated as restricted roads. The restricted roads will initially be the subject of a 30mph speed limit, but will become the subject of a 20mph speed limit after September 2023 as a consequence of the new restricted roads speed limit legislation that has been made by the Welsh Government.
- 1.7. All other adopted highways within the town that are not specified in the Order but are illuminated by a system of street lighting will also become the subject of a 20mph speed limit after September 2023 as a consequence of the new restricted roads speed limit legislation that has been made by the Welsh Government.
- 1.8. The proposal includes the revocation of existing restricted roads traffic regulation Orders listed below to enable the new speed limit extents to be more clearly and accurately defined by the new traffic regulation Order :-
 - a. *The County Council of Montgomery (Restricted Roads) (No.1) Order 1963.*
 - b. *The County Council of Montgomery (Restricted Roads) (No.2) Order 1963.*
 - c. *The County of Powys (Forden Road and Kerry Road, Montgomery) (Restricted Roads) (No.1) Order, 1978.*
 - d. *The County of Powys (Forden Road, Montgomery) (Restricted Roads) (No.1) Order, 1981.*
 - e. *The County of Powys (New Road, Montgomery) (Restricted Roads) (No.1) Order, 1991.*
 - f. *The County of Powys (Bishop's Castle Road, Montgomery) (Restricted Roads) (No.1) Order, 1992.*
- 1.9. Copies of the Orders to be revoked and an indicative plan showing the extents of those Orders are attached at Appendix C for reference purposes.

- 1.10. To avoid any confusion and for the purposes of clarity, the proposed speed limit extents contained within the traffic order are identified on a plan and as written descriptions of individual speed limit extents along those roads within the draft Order. The plan is attached at Appendix A and will be available to view on site notices and on the Council's website during the public consultation phase of the traffic order making process.
- 1.11. The Council's statement of reasons is attached to this report at Appendix B.

2. Advice

- 2.1. No other options are available for consideration at this stage of the Traffic Regulation Order proposal process.
- 2.2. The County Council has engaged with the Town Council and the county councillor whose ward is directly affected by the proposed speed limit modifications.
- 2.3. The proposals support the CIP priority of improving our transport infrastructure by making it safer for people to use the highways within Montgomery and to encourage active travel movements.

3. Resource Implications

- 3.1. All costs associated with the consultation process, the implementation of the Traffic Regular Order and the associated carriageway markings and signage along Forden Road will be funded by the developer.
- 3.2. All the other speed limit terminal and repeater signs that will need to be erected along the other roads in Montgomery will be funded from the existing highway maintenance budget.
- 3.3. The Head of Finance (Section 151 Officer) notes the report.

5. Legal implications

- 3.4. The Principal Legal Assistant (North) has reviewed the proposals and confirms it is within our power as long as the correct process is followed.
- 3.5. The Head of Legal Services and the Monitoring Officer has commented as follows: "I note the legal comment and have nothing to add to the report".

6. Data Protection

- 3.6. Personal data will be collected from responses to the public consultation and is essential to undertake this statutory requirement for making a

Traffic Regulation Order. This data will be collected and managed in accordance with the privacy notice that is published on the Traffic Order Consultation page on our website.

- 3.7. The Data Protection Officer notes the processing of personal data in connection with this proposal and makes no further comment.

7. Comments from local members

- 7.1. The proposal will affect residents, businesses, and visitors to Montgomery. Cllr Jeremy Brignell-Thorp has expressed his support for the proposal, as have Dyfed-Powys Police and Montgomery Town Council.

8. Integrated Impact Assessment

- 8.1. An impact assessment is not required.

Recommendation:	Reason for Recommendation:
<p>1. To resolve that the Traffic Regulation Order consultation procedure is initiated in accordance with The Local Authorities' Traffic Orders (Procedure) (England and Wales) Regulations 1996 for the proposed modification of the existing speed limits and the introduction of new speed limits along various roads in the town of Montgomery as set out in the plans in Appendix A; and if no substantive objections are received the proposal be implemented.</p> <p>2. To revoke the existing restricted roads Orders listed at Appendix C.</p>	<p>To modify the extents of the existing restricted roads speed limits and introduce new 30 mph and 40 mph speed limit buffer zones to mitigate speed concerns and secure the planning gain element of the housing development, in the interests of highway safety.</p>

Relevant Policy:	Corporate Improvement Plan 2021-25 : Improve our Infrastructure to Support Regeneration and Attract Investment - We will actively compete for any grant funding opportunities, and subject to such funding, deliver transport infrastructure projects, develop active travel, support suitable transport options and improve road safety.		
Within Policy:	Y /N	Within Budget:	Y /N

Relevant Local Member(s):	Cllr Jeremy Brignell-Thorp - member for the Forden and Montgomery ward.
----------------------------------	--

Person(s) To Implement Decision:	Chris Lloyd
Date By When Decision To Be Implemented:	As soon as possible

Is a review of the impact of the decision required?	Y/ N
---	------

Contact Officer:	Chris Lloyd
Tel:	01686 611563
Email:	chris.lloyd@powys.gov.uk
Head of Service:	Matt Perry
Corporate Director:	Nigel Brinn

Background Papers used to prepare Report:

- **Appendix A - Proposed speed limit traffic regulation Order plans.**
- **Appendix B - Statement of reasons.**
- **Appendix C – Existing speed limit traffic regulation Orders to be revoked.**

DELEGATED DECISION NEW REPORT TEMPLATE VERSION 3

This page is intentionally left blank

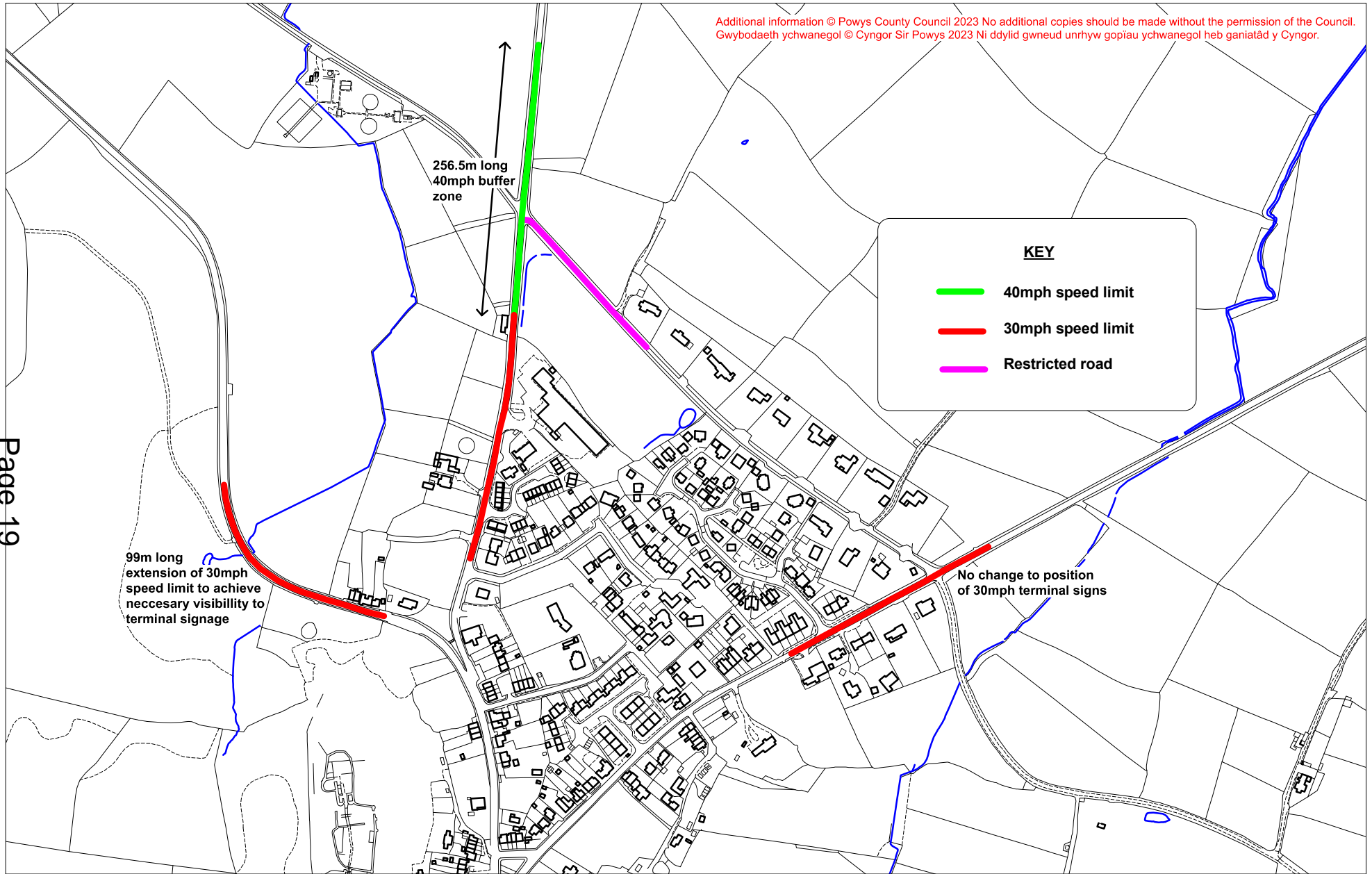

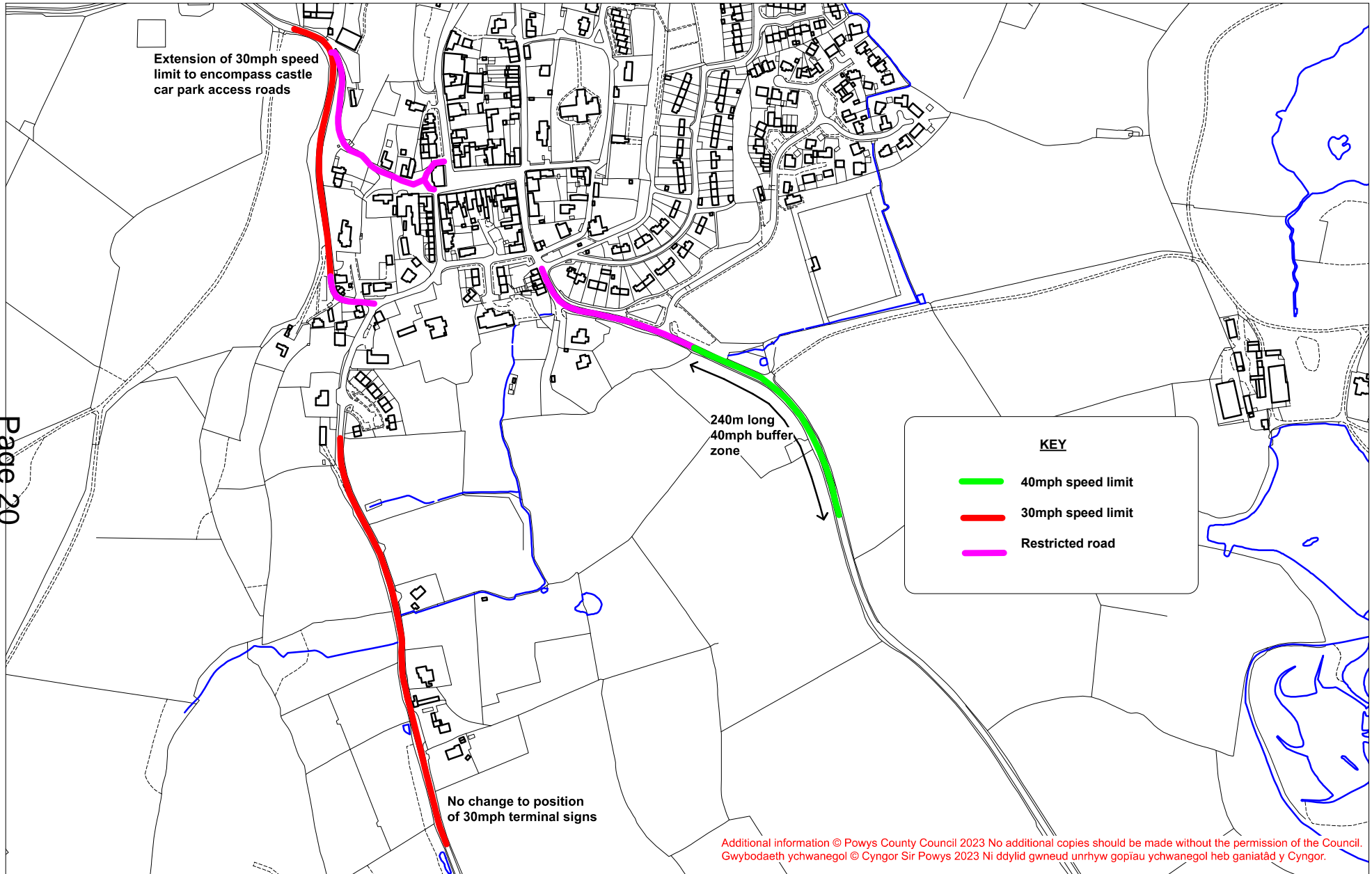

Additional information © Powys County Council 2023 No additional copies should be made without the permission of the Council. Gwybodaeth ychwanegol © Cyngor Sir Powys 2023 Ni ddylid gwneud unrhyw gopiau ychwanegol heb ganiatâd y Cyngor.

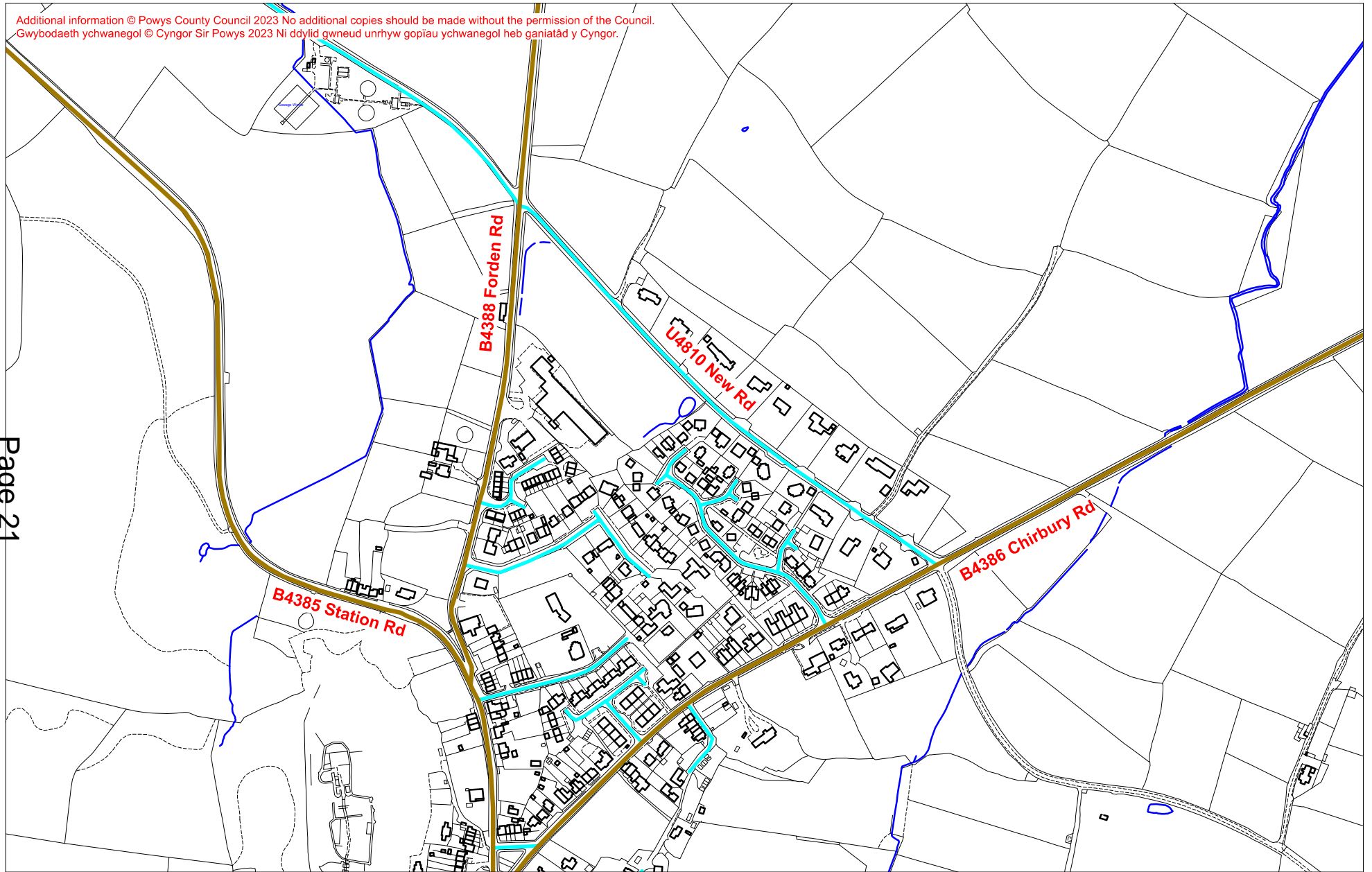

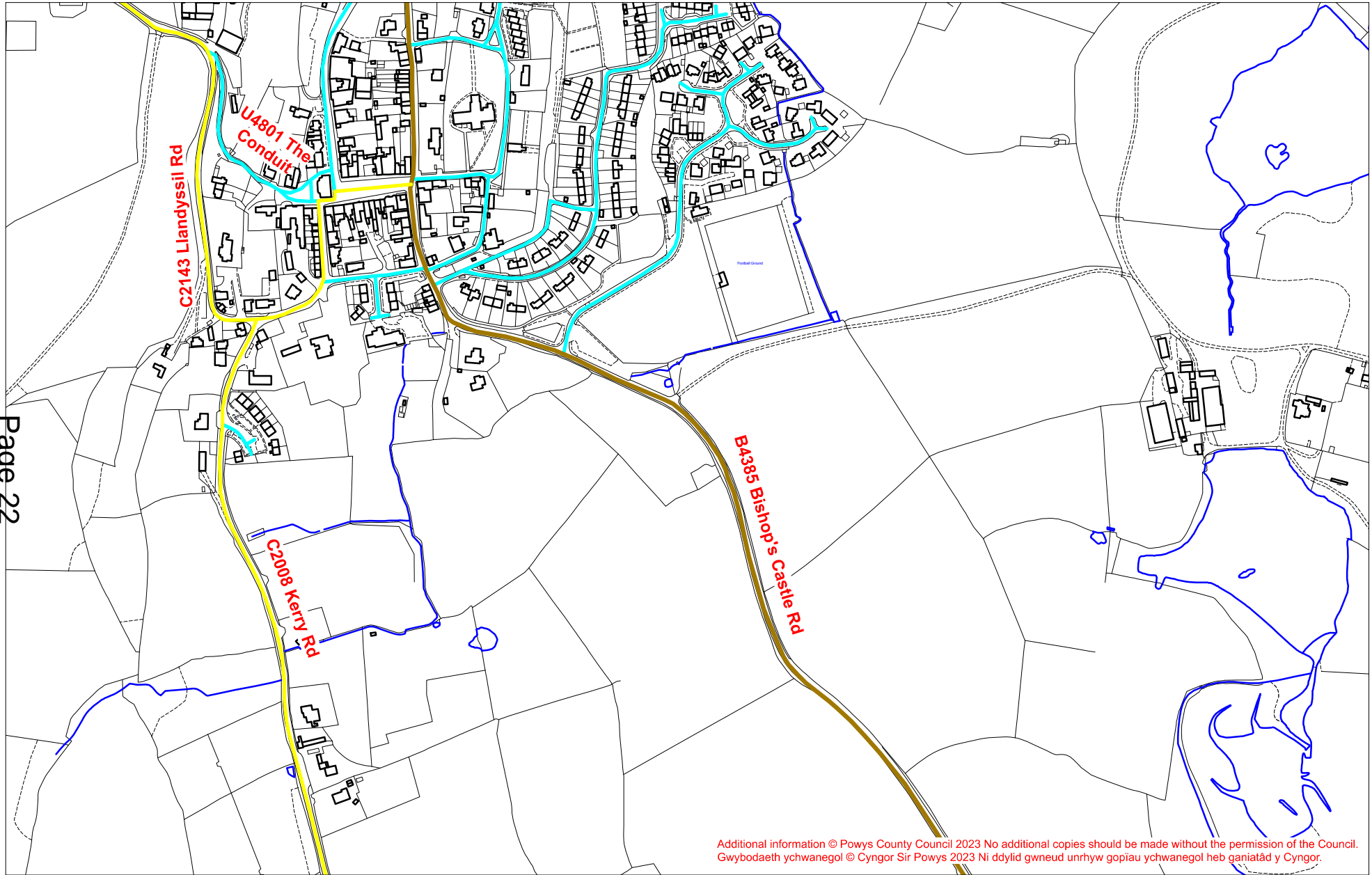

Additional information © Powys County Council 2023 No additional copies should be made without the permission of the Council.
Gwybodaeth ychwanegol © Cyngor Sir Powys 2023 Ni ddylid gwneud unrhyw gopïau ychwanegol heb ganiatâd y Cyngor.

**The County of Powys (Various Roads, Montgomery)
(40 MPH Speed Limit, 30 MPH Speed Limit and Restricted Roads) Order 2023**

Statement of Reasons

Full planning consent reference 20/2118/FUL has been secured by a developer to erect 33 affordable local need dwellings, formation of vehicular access road and all associated works on land off Forden Road, Montgomery. One of the developer's obligations with respect to their planning consent is to modify the extent of the existing 30mph speed limit and introduce a new 40mph buffer zone speed limit along Forden Road. A traffic regulation Order would be required to modify the speed limits along Forden Road.

The developer has already paid the Council's fee to process the speed limit traffic regulation Order.

The developer will also be funding the required signage and carriageway markings associated with the new and modified speed limits along Forden Road and New Road.

As part of the same traffic regulation Order proposal, the local highway authority is seeking to make modifications to the existing speed limits on other roads within the town of Montgomery to take into account traffic speed concerns raised by Montgomery Town Council and to eliminate minor discrepancies that currently exist between the existing restricted roads traffic regulation Order extents and the existing locations of certain speed limit terminal signs.

A small number of non-illuminated speed limit terminal signs will need to be erected along Llandyssil Road and Bishop's Castle Street to facilitate the modified speed limit proposal; and the existing non-illuminated 30mph speed limit signs will need to be relocated further along Station Road to facilitate the new speed limit Order. These minor costs will be funded by the local highway authority.

The new speed limit Order will specify which sections of road will be designated as 30mph and 40mph speed limit roads, and which sections of road will be designated as restricted roads. The restricted roads will initially be the subject of a 30mph speed limit, but will become the subject of a 20mph speed limit after September 2023 as a consequence of the new restricted roads speed limit legislation that has been made by the Welsh Government.

All other adopted highways within the town that are not specified in the Order but are illuminated by a system of street lighting will also become the subject of a 20mph speed limit after September 2023 as a consequence of the new restricted roads speed limit legislation that has been made by the Welsh Government.

The proposal includes the revocation of existing restricted roads traffic regulation Orders listed below to enable the new speed limit extents to be more clearly and accurately defined by the new traffic regulation Order :-

- a. *The County Council of Montgomery (Restricted Roads) (No.1) Order 1963.*
- b. *The County Council of Montgomery (Restricted Roads) (No.2) Order 1963.*
- c. *The County of Powys (Forden Road and Kerry Road, Montgomery) (Restricted Roads) (No.1) Order, 1978.*
- d. *The County of Powys (Forden Road, Montgomery) (Restricted Roads) (No.1) Order, 1981.*
- e. *The County of Powys (New Road, Montgomery) (Restricted Roads) (No.1) Order, 1991.*
- f. *The County of Powys (Bishop's Castle Road, Montgomery) (Restricted Roads) (No.1) Order, 1992.*

Copies of the Orders to be revoked and an indicative plan showing the extents of those Orders are attached at Appendix C for reference purposes.

To avoid any confusion and for the purposes of clarity, the proposed speed limit extents contained within the traffic order are identified on a plan and as written descriptions of individual speed limit extents along those roads within the draft Order. The plan is attached at Appendix A and will be available to view on site notices and on the Council's website during the public consultation phase of the traffic order making process.

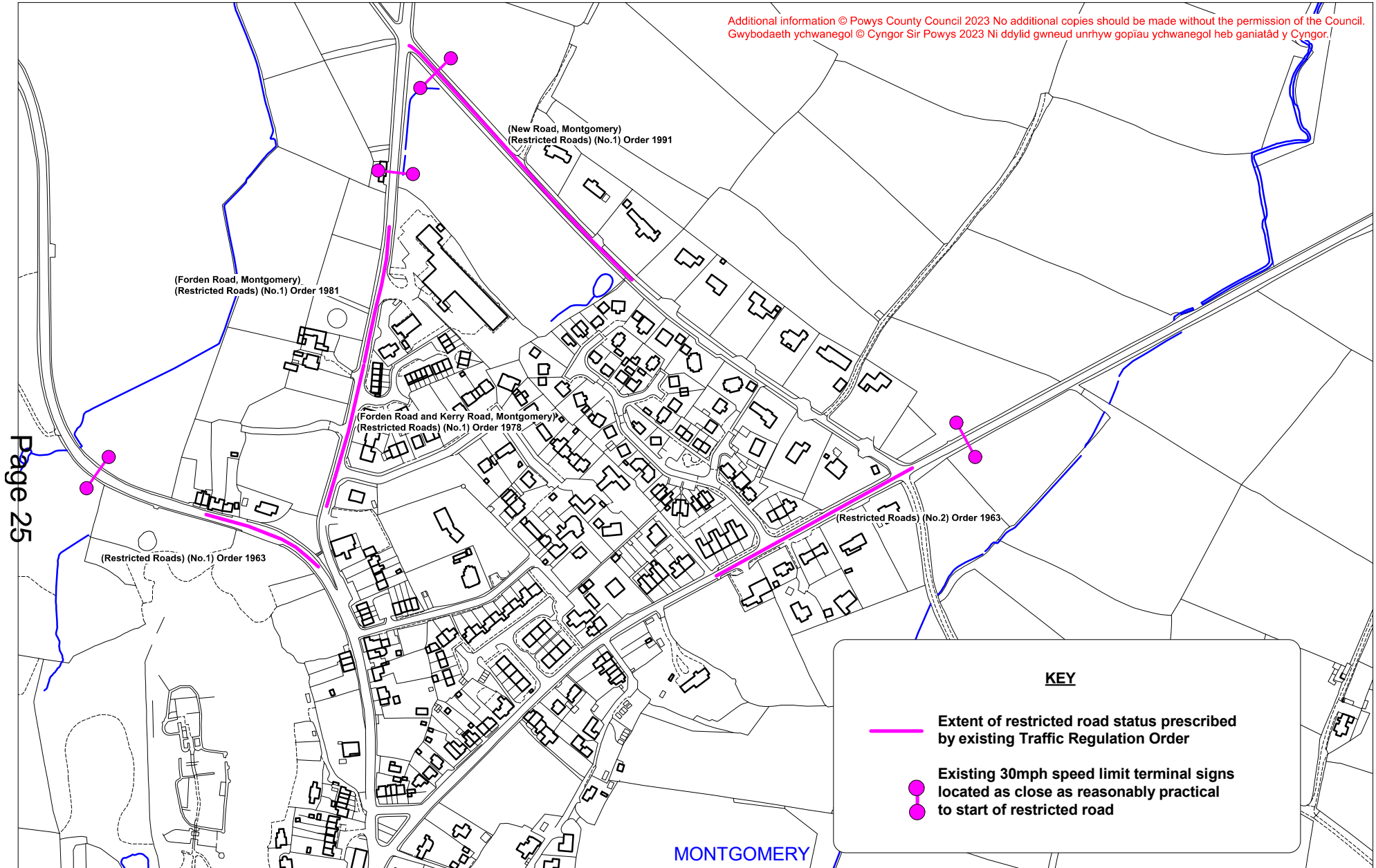

KEY

- Extent of restricted road status prescribed by existing Traffic Regulation Order
- Existing 30mph speed limit terminal signs located as close as reasonably practical to start of restricted road

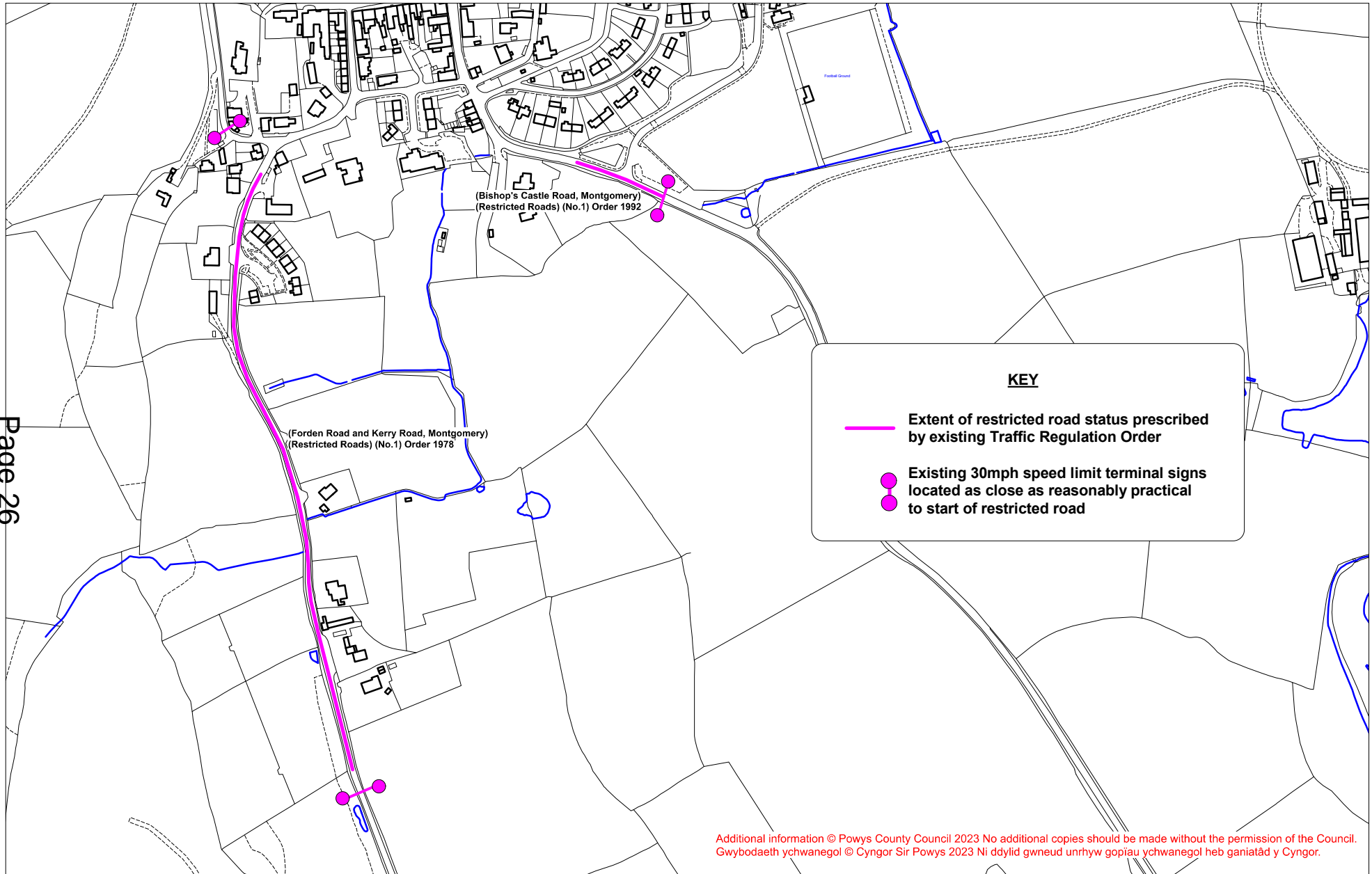

Additional information © Powys County Council 2023 No additional copies should be made without the permission of the Council.
Gwybodaeth ychwanegol © Cyngor Sir Powys 2023 Ni ddylid gwneud unrhyw gopïau ychwanegol heb ganiatâd y Cyngor.

ROAD TRAFFIC ACT 1960The County Council of Montgomery (Restricted Roads) (No.1)
Order 1963

The County Council of Montgomery in exercise of their powers under Section 20(3) and Section 21(1) of the Road Traffic Act 1960, after consultation with the Chief Officer of Police for Mid-Wales and with the consent of the Minister of Transport, hereby order and direct as follows :-

1. The length of road specified in the Schedule to this Order shall become a restricted road for the purposes of Section 19 of the Road Traffic Act 1960.
2. The Interpretation Act 1889 shall apply for the interpretation of this Order as it applies for the interpretation of an Act of Parliament.
3. This Order may be cited as "The County Council of Montgomery (Restricted Roads) (No.1) Order 1963"

Dated 8th January 1964.

THE COMMON SEAL OF THE
COUNCIL OF THE ADMINISTRATIVE
COUNTY OF MONTGOMERY was
hereunto affixed in the
presence of -

J. W. J. Jones
Vice-Chairman

P. E. White

Clerk

SCHEDULE

That length of the Leintwardine-Neuadd Bridge Road (B.4385), known as Station Road, Montgomery, which extends from a point 37 yards north-west of its junction with the Montgomery-Forden-Kingswood-Buttington Road (B.4388) to a point 144 yards north-west of that junction.

ROAD TRAFFIC ACT 1960

The County Council of Montgomery (Restricted Roads) (No.2)
Order 1963

The County Council of Montgomery in exercise of their powers under section 20(3) and section 21(1) of the Road Traffic Act 1960, after consultation with the Chief Officer of Police for Mid-Wales and with the consent of the Minister of Transport, hereby order and direct as follows :-

1. The length of road specified in the Schedule to this Order shall become a restricted road for the purposes of section 19 of the Road Traffic Act 1960.
2. The Interpretation Act 1889 shall apply for the interpretation of this Order as it applies for the interpretation of an Act of Parliament.
3. This Order may be cited as "The County Council of Montgomery (Restricted Roads) (No.2) Order 1963".

Dated 8th January 1964.

THE COMMON SEAL OF THE
COUNCIL OF THE ADMINISTRATIVE
COUNTY OF MONTGOMERY was
hereunto affixed in the
presence of -



J. W. Jones
Chairman

P. E. White
Clerk

SCHEDULE

That length of the Abermule - Shrewsbury Road (B.4386), known as Chirbury Road, Montgomery, which extends from a point 380 yards north-west of its junction with the Leintwardine - Neuadd Bridge road (B.4385) in a north-westerly direction for a distance of approximately 188 yards.

THE COUNTY OF POWYS

(FORDEN ROAD AND KERRY ROAD, MONTGOMERY) (RESTRICTED ROADS) (NO. 1)

ORDER, 1978

THE COUNTY COUNCIL OF POWYS in exercise of their powers under Sections 72(3) and 73(1) of the Road Traffic Regulation Act, 1967, as amended by Part IX of the Transport Act, 1968, and Schedule 19 to the Local Government Act, 1972, and of all other powers them enabling in that behalf and after consultation with the Chief Officer of Police in accordance with Section 84C(1) of the said Act of 1967, hereby make the following Order :-

1. The lengths of roads specified in the Schedule to this Order shall become restricted roads for the purposes of Section 71 of the Road Traffic Regulation Act, 1967.
2. The Interpretation Act, 1889, shall apply for the interpretation of this Order as it applies for the interpretation of an Act of Parliament.
3. This Order shall come into operation on the Fifteenth day of January 1979, and may be cited as "The County of Powys (Forden Road and Kerry Road, Montgomery) (Restricted Roads) (No. 1) Order, 1978".

S C H E D U L E

1. That length of the B.4388 Montgomery to Buttington Road known as Forden Road, Montgomery, which extends from a point 80 yards north of the junction with the B.4385 Station Road in a northerly direction to a point 206 yards north of that junction, a distance of 126 yards.

2. That length of the Class III 8 Kerry Road, Montgomery, which extends from a point 30 yards south of the junction with the Class III 143 Montgomery to Llandyssil Road in a southerly direction to a point 600 yards south of that junction, a distance of 570 yards.

GIVEN under the Common Seal of the County Council of Powys the fifteenth day of December 1978.

THE COMMON SEAL of the COUNTY)
COUNCIL OF POWYS was hereunto)
affixed in the presence of :)



Jed Morgan
Member

Seal no. 1034.

W.M.R.D.
County Solicitor

THE COUNTY OF POWYS

(FORDEN ROAD, MONTGOMERY) (RESTRICTED ROADS) (NO.1) ORDER, 1981

THE COUNTY COUNCIL OF POWYS in exercise of their powers under Sections 72 (3) and 73(1) of the Road Traffic Regulation Act, 1967, as amended by Part IX of the Transport Act, 1968, and Schedule 19 to the Local Government Act, 1972, and of all other powers them enabling in that behalf and after consultation with the Chief Officer of Police in accordance with Section 84C (1) of the said Act of 1967, hereby make the following Order :-

1. The length of road specified in the Schedule to this Order shall become a restricted road for the purposes of Section 71 of the Road Traffic Regulation Act, 1967.
2. This Order shall come into operation on the thirteenth day of July One thousand nine hundred and eighty-one and may be cited as The County of Powys (Forden Road, Montgomery) (Restricted Roads) (No.1) Order, 1981.

SCHEDULE

Length of road in the town of Montgomery

That length of the County Classified Road No.B.4388 known as Forden Road which extends from the present terminal point of the 30 m.p.h. speed restriction in a northerly direction for a distance of approximately one hundred and nine metres.

GIVEN under the Common Seal of the County Council of Powys this first day of July One thousand nine hundred and eighty-one

THE COMMON SEAL of THE COUNTY)
COUNCIL OF POWYS was hereunto)
affixed in the presence of :-)

Chairman/Member

County Solicitor

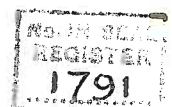

THE COUNTY OF POWYS
(NEW ROAD, MONTGOMERY)
(RESTRICTED ROADS) (NO.1) ORDER 1991

THE COUNTY COUNCIL OF POWYS in exercise of its powers under Sections 82(2) and 83(2) of the Road Traffic Regulation Act, 1984 ("the Act") and of all other enabling powers and after consultation with the Chief Officer of Police in accordance with Part III of Schedule 9 to the Act hereby makes the following Order:-

1. The length of road specified in the Schedule to this Order shall become a restricted road for the purposes of Section 81 of the Act.
2. This Order shall come into operation on the fourteenth day of January One thousand nine hundred and ninety-one and may be cited as The County of Powys (New Road, Montgomery) (Restricted Roads) (No.1) Order, 1991.

SCHEDULE

Length of Road in the Community of Montgomery in the District of Montgomeryshire

That length of the County unclassified road known as New Road which extends from the existing terminal point of the thirty miles per hour speed restriction (that is at a point adjacent to the north-western boundary of the property known as Felin Fawr) for a distance of approximately 258 metres (282 yards) in a north-westerly direction to its junction with the B4388 Montgomery to Buttington road.

GIVEN under the Common Seal of the County Council of Powys this eighth day of January One thousand nine hundred and ninety-one.

THE COMMON SEAL of THE COUNTY)
COUNCIL OF POWYS was hereunto)
affixed in the presence of:-)

County Solicitor



THE COUNTY OF POWYS
(BISHOP'S CASTLE ROAD, MONTGOMERY)
(RESTRICTED ROADS)(NO. 1) ORDER 1992

THE COUNTY COUNCIL OF POWYS in exercise of its powers under Sections 82(2) and 83(2) of the Road Traffic Regulation Act, 1984 ("the Act") and of all other enabling powers and after consultation with the Chief Officer of Police in accordance with Part III of Schedule 9 to the Act hereby makes the following Order:-

1. The length of road specified in the Schedule to this Order shall become a restricted road for the purposes of Section 81 of the Act.
2. This Order shall come into operation on the tenth day of August one thousand nine hundred and ninety-two and may be cited as The County of Powys (Bishop's Castle Road, Montgomery) (Restricted Roads) (No. 1) Order, 1992.

SCHEDULE

Length of Road in the Community of Montgomery

That length of the County Classified Road number B4385 known as Bishop's Castle Road which extends from a point approximately 106 metres (116 yards) south-east of its junction with the County unclassified road known as Tan-y-Mur Estate Road (that is at the existing terminal point of the 30 miles per hour speed restriction) for a distance of approximately 79 metres (86 yards) in a south-easterly direction to a point approximately 40 metres (44 yards) south-east of its junction with the access road to New Acre Wood housing development.

GIVEN under the Common Seal of the County Council of Powys this sixth day of August one thousand nine hundred and ninety-two

THE COMMON SEAL of THE COUNTY)
COUNCIL OF POWYS was hereunto)
affixed in the presence of:-)

[Signature]
Assistant Chief Executive ~~and County Treasurer~~



O2904GS.LR -
PAGE 3



This page is intentionally left blank